

Type RPUS-L Slip-On Roll Prong

The type RPUS-L Slip-On Roll Prong is designed for Prongs up to Ø82mm 'Under Slung' from the Fork Tines and is suitable for fabric, cable and coil products. These attachments quickly adapt to Forklifts rated up to 2.5 Tonne requiring only the connection of the Safety Chain to prevent unintentional disengagement. Prongs are manufactured from high tensile steel and can be made to any length. The Safe Working Load (SWL) of this unit varies depending on Prong chosen.

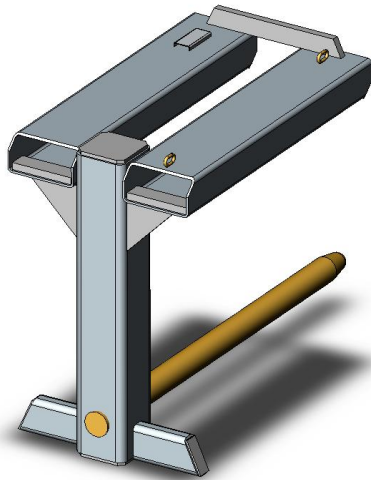

SPECIFICATIONS:

- Safe Working Load (SWL) – refer chart below
- Unit Weight – refer chart below
- Point type as shown in diagram
- Standard finish – painted enamel
- Refer diagram below for all other specifications

(RPUS-L with Ø82mm x 1200mm long Prong shown)

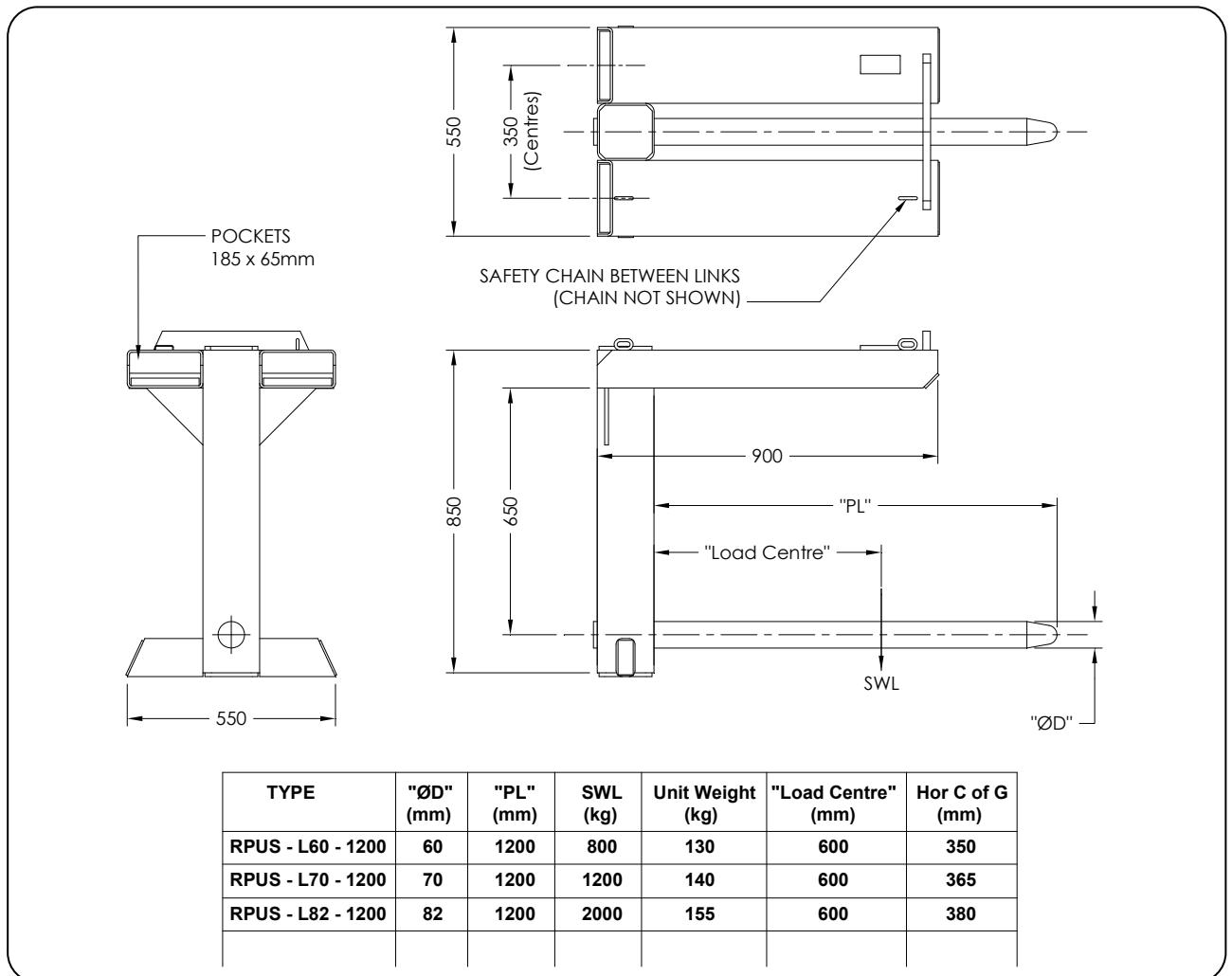

We Gladly Accept



Proudly distributed by

RJ Cox Engineering

www.coxengineering.com.au
info@coxengineering.com.au

1 1

Ph: 02) 9486 3006
 Fax: 02) 9486 3009