

Type RPC-QR3 Carriage Mounted Roll Prong (Class III)

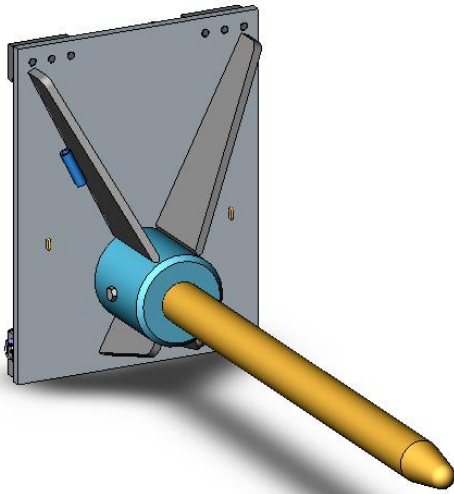

The type RPC-QR3 Carriage Mounted Roll Prong is suitable for carpet, vinyl, fabric or similar products. This unit has been designed with a Class III mounting and features Quick Release lower Carriage Hooks and a spring loaded locating pin for easy installation.

Prongs are manufactured from high tensile steel and can be made to any length. The Safe Working Load (SWL) of this unit varies depending on Prong chosen. For Class II mountings refer RPC-QR2.

SPECIFICATIONS:

- Safe Working Load (SWL) – refer chart below
- Lost Load 200mm
- Unit Weight – refer chart below
- Standard finish – painted enamel
- Refer diagram below for all other specifications

(RPC-QR3 with Ø80mm Prong shown)

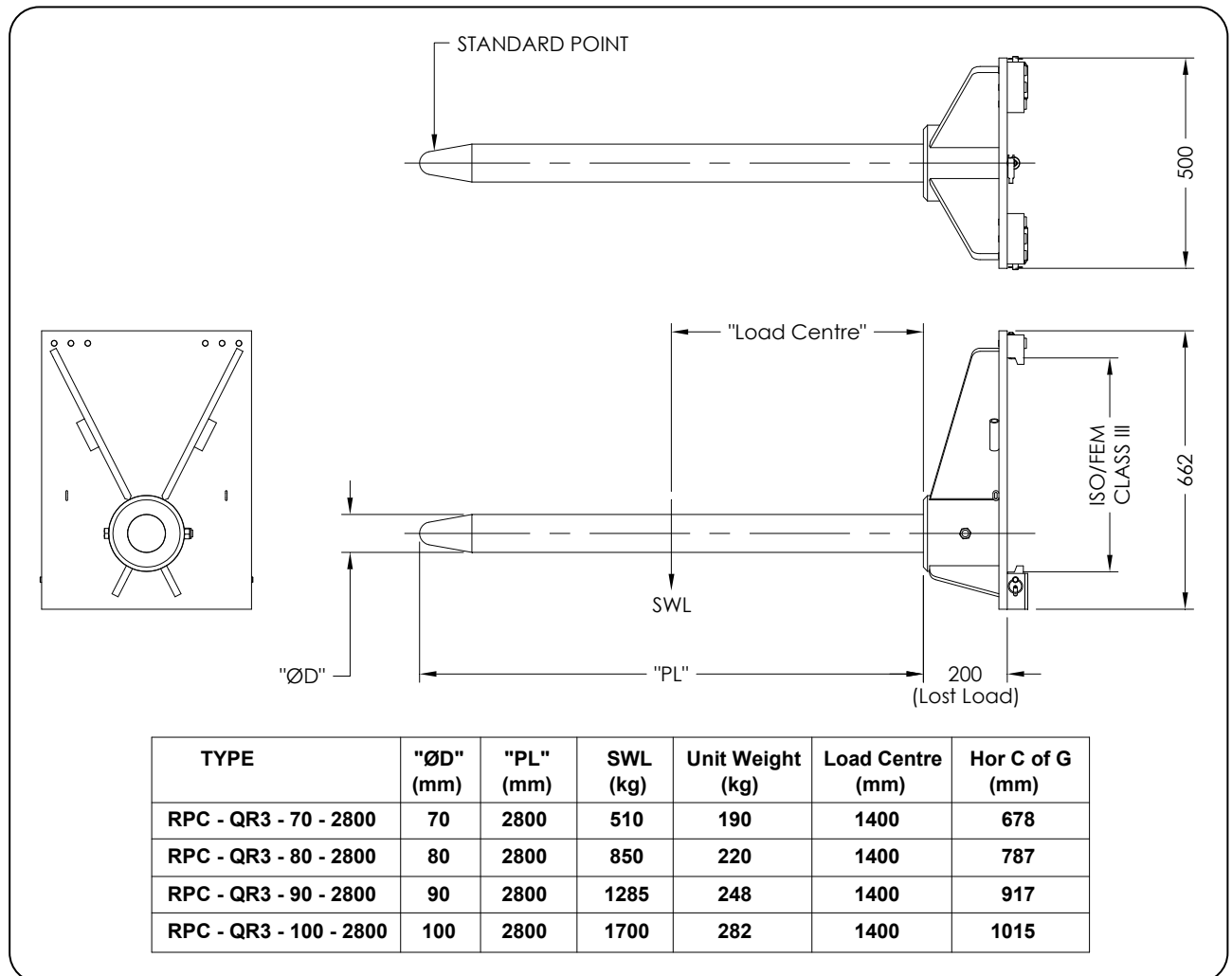

We Gladly Accept



Proudly distributed by

RJ Cox Engineering

www.coxengineering.com.au
info@coxengineering.com.au

Ph: 02) 9114 6867
 Fax: 02) 9486 3009